

HOW TO INSTALL SLIME SELF-SEALING TUBES

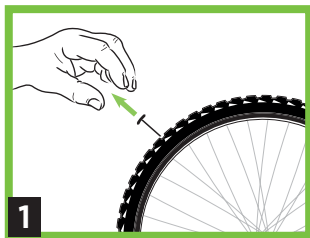

1
Deflate tire. Remove any puncturing objects.

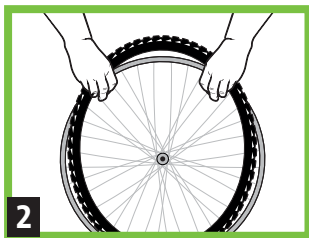

2
Work one side of the tire off the rim. Remove old tube.

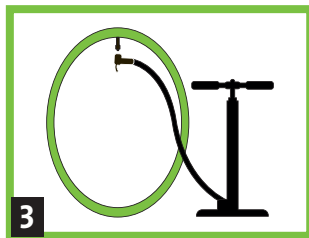

3
Before installing, slightly inflate new tube to give it shape.

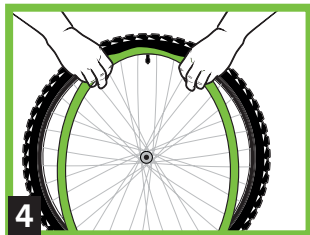

4
Insert tube valve through rim hole. Gently push the tube into place inside the tire.

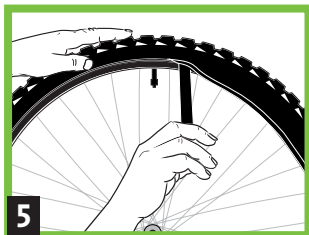

5
Work tire back onto rim being careful not to pinch the tube. Use of tire levers is recommended.

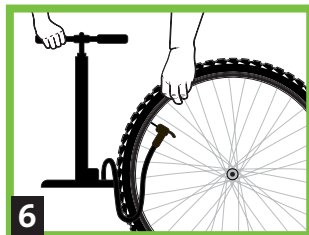

6
Ensure tire bead is consistently seated around both sides of tire. Inflate to proper PSI.

NOTE: Slime is Not Guaranteed to seal sidewall punctures, pinch flats, glass cuts or punctures over 1/8" (3mm). Be sure to remove any foreign puncturing objects from tire. If necessary, reinflate tire and rotate wheel to create seal. Prior to inflating or deflating a Slime Self-Sealing Tube, rotate tire so valve is at the 10 or 2 o'clock position. This helps sealant to flow away from the valve preventing it from clogging the valve or air source. Do not overinflate tire.

WARNING: Eye protection must be worn during installation.